

Efficient front loader for heavy-duty milling operations.
W 120 XTi Cold Milling Machine



US VERSION

Highlights of the Cold Milling Machine at a Glance

02
03

1 | HIGH-PRECISION, INTUITIVE LEVELING WITH LEVEL PRO PLUS

- > Simple, intuitive operation of **LEVEL PRO PLUS**
- > Fully integrated into the machine control system
- > Numerous additional and automatic functions
- > Milling depth measurement via displacement sensors installed in the hydraulic side plate cylinders

2 | EFFICIENT MULTIFUNCTIONAL ARMREST

- > Ergonomically designed multifunctional armrest with color control panel
- > Additional machine height adjustment function built into the multifunctional armrest
- > Scraper position indicated on the control screen
- > User-programmable favorites buttons

3 | UNPARALLELED VISIBILITY CONCEPT AND COMFORT

- > Excellent forward visibility thanks to reduced chassis width on the right
- > Significantly improved visibility thanks to laterally adjustable operator's platform
- > Easy access with "welcome and go home" lighting

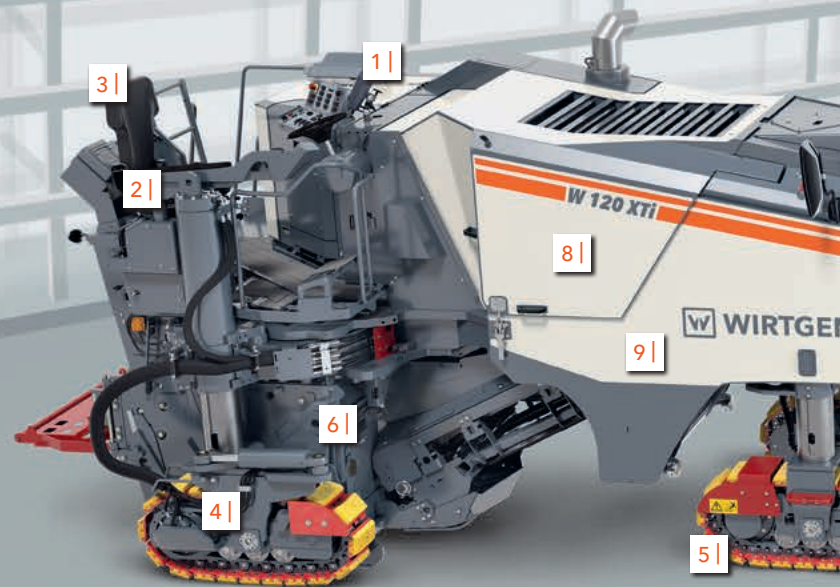

4 | QUICK-PIVOTING, RIGHT-HAND REAR TRACK UNIT

- > Rapid, automatic pivoting of the right-hand rear track unit without needing to lower the milling drum
- > Extremely robust sliding bearing
- > Heavy-duty crawler track design for rugged milling applications

5 | QUICK AND PRECISE MANEUVERING

- > Large steering angle for small turning radius
- > Right-hand rear track unit with automatic self-steering
- > Additional height adjustment in increments of 0.04 in or 0.2 in (1 mm or 5 mm)



8 |

HIGH-POWERED ENGINES FOR TREMENDOUS PRODUCTIVITY

- > State-of-the-art engine technology meets tough US EPA Tier 4f emissions standards
- > Impressive engine performance with high maximum torque
- > Three different milling drum speeds

9 |

HIGH TRACTION AND OPTIMIZED WEIGHT

- > Automatic positioning function with relief sensors
- > Automatic WIDRIVE functions significantly reduce operator intervention, allowing for one-person operation
- > Compact dimensions and low weight for ideal transport conditions

7 |

6 |

OUTSTANDING MILLING PERFORMANCE IN ANY APPLICATION

- > Comes standard with extremely wear-resistant HT22 quick-change toolholder system
- > New HT22 **PLUS** toolholder upper part with increased service life
- > Automated water injection into the milling unit
- > 1 ft 6 in (450 mm) side plate travel on right side

7 |

OUTSTANDING PERFORMANCE AND FLEXIBILITY WHEN LOADING

- > Wide conveyor swing angles of 60° to the right and left
- > Two conveyor swing speeds for high-precision material loading
- > Heavy-duty conveyor suspension for flexible loading
- > Hydraulic folding conveyor for quick folding during operation on site

Operating Highlights

04
05

SIMPLE, INTUITIVE OPERATION OF LEVEL PRO PLUS

The **LEVEL PRO PLUS** leveling system developed especially for cold milling machines offers easy and intuitive one-hand operation using the rotary knob, and the menu can be configured as desired. **LEVEL PRO PLUS** stands out due to its precise milling results.

DISPLACEMENT SENSORS

The reference line is scanned via heavy-duty displacement sensors built into the hydraulic side plate cylinders and displayed directly on the high-resolution **LEVEL PRO PLUS** control panel.

FULLY INTEGRATED

The **LEVEL PRO PLUS** leveling system is fully integrated into the machine control system, enabling a high degree of automation.

ERGONOMICALLY DESIGNED MULTIFUNCTIONAL ARMREST

The multifunctional, individually adjustable armrest combines innovative design with perfect user-friendliness. Important data is displayed on the color control panel. The multifunctional armrest is also perfectly integrated into the WIRTGEN cold milling machine family's standardized user interface, guaranteeing productive operation right from the start.

SCRAPER POSITION

The scraper position is detected by a displacement sensor and shown on the control panel.

FAVORITES BUTTONS

Four buttons can be programmed with twenty different functions as required by the operator.



FRONT VIEW

The deliberately slim chassis offers a clear view of the milled edge from the front. The operator also has an excellent view directly in front of the milling drum unit.

MOVABLE OPERATOR'S PLATFORM

The operator's platform can be hydraulically moved outwards by 7.9 in (200 mm) to provide an optimal view of the milling drum unit and the front right-hand track unit.

ADDITIONAL AND AUTOMATIC FUNCTIONS

The **LEVEL PRO PLUS** leveling system offers many automatic and additional functions that make the operator's job easier. This also speeds up work processes.



The efficient multifunctional armrest.

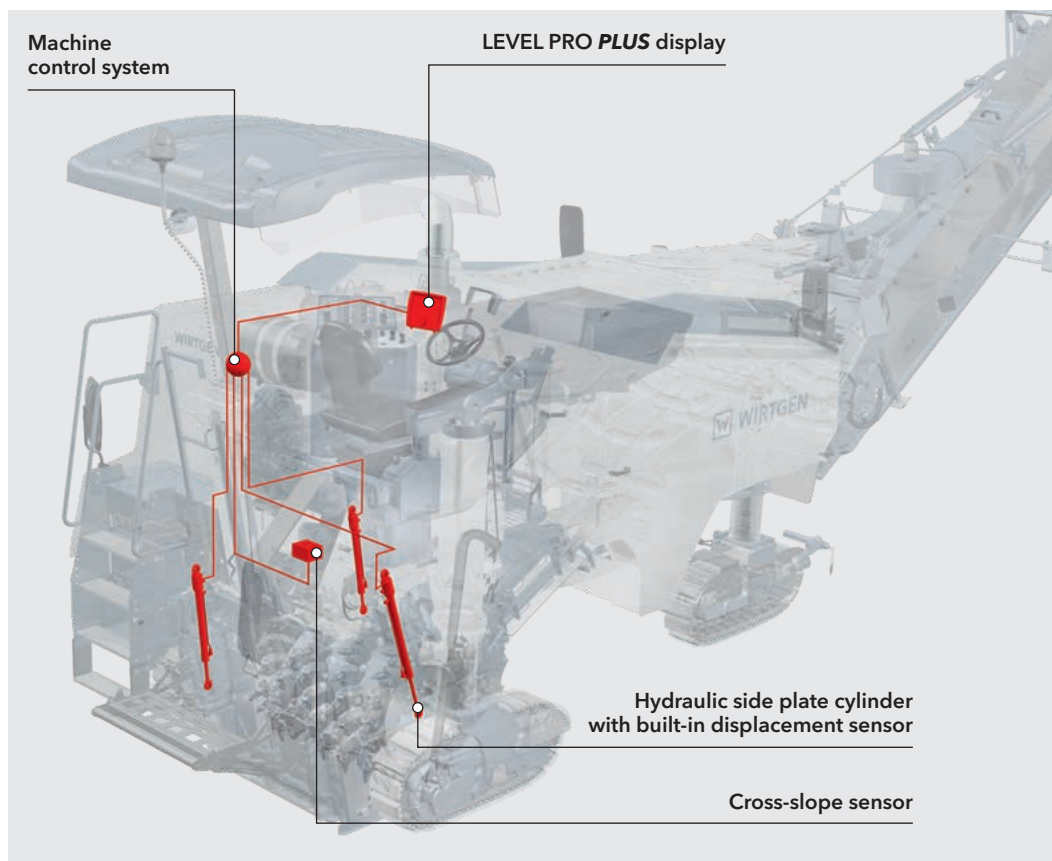

The leveling system uses a variety of different sensors.

ADDITIONAL HEIGHT ADJUSTMENT

The hydraulically proportional machine height adjustment including the milling depth memory feature is conveniently controlled via the multifunctional armrest.

"WELCOME" AND "GO HOME" LIGHTING

The access ladder and operator's platform can be brightly illuminated when approaching and walking away from the machine. The operator's platform can be easily accessed from the rear of the machine.



Driving and Steering Highlights

06
07

AUTOMATIC PIVOTING

The right-hand rear track unit can be pivoted in front of the milling drum hydraulically from the operator's platform to allow milling along curbs or other obstacles - without having to lower the milling drum to the ground. This process can be completed extremely quickly in thirty seconds or less. And since the milling drum is not in contact with the ground during the pivoting process, there is no risk of damage to the picks or the milled surface.

AUTOMATIC SELF-STEERING FEATURE

When pivoted in front of the milling drum, the right-hand rear track unit's automatic self-steering feature not only gives the cold milling machine maximum maneuverability, but also minimizes wear on the base plates.

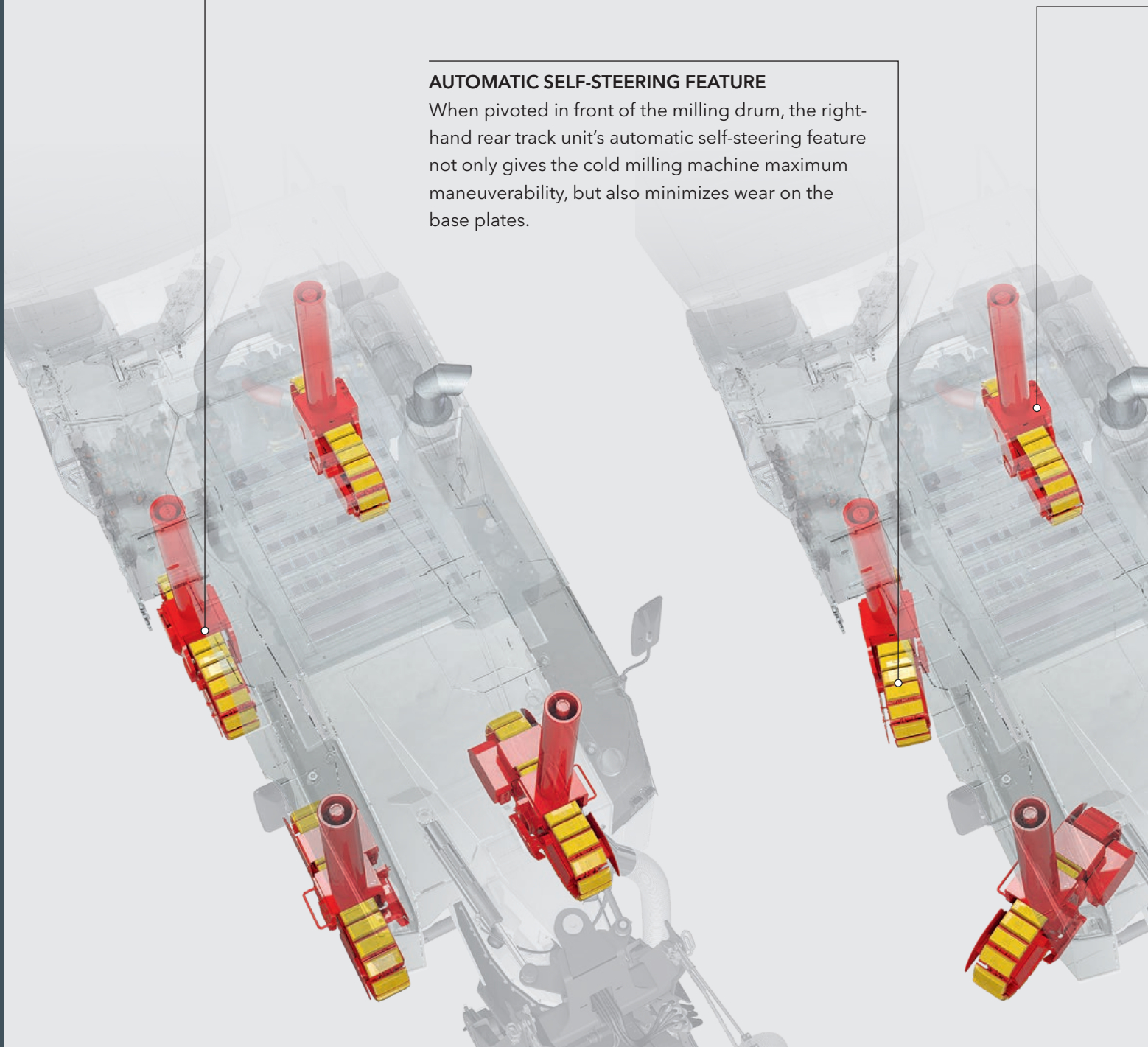

INCREMENTAL HEIGHT ADJUSTMENT

The additional height adjustment feature on the left-hand control panel allows the operator to precisely adjust the milling depth in increments of 0.04 in or 0.2 in (1 mm or 5 mm).

FIRM LOCKING

The secure connection of the right-hand rear track unit to the chassis in the final position minimizes wear and increases precision.

EXTREMELY RUGGED SLIDING BEARING

The rugged, wear-resistant sliding bearing minimizes play in the kinematics, guaranteeing consistent, high-precision milling results.

HEAVY-DUTY TRACK UNIT DESIGN

The pivot arm's rugged design with only two pivot points makes tough milling operations and precise pivoting of the right-hand rear crawler track into and out of the machine possible.



Impressive steering angle for use on narrow job sites.

LARGE STEERING ANGLES

The large steering angles to the left and right guarantee small turning radii and thus rapid maneuvering, even in tight spaces.



Precise milling along obstacles.



Milling and Loading Highlights

08
09

LARGE BELT WIDTH AND CLEAT HEIGHT

A large belt width and cleat height guarantee a high conveying capacity.

HEAVY-DUTY CONVEYOR SUSPENSION

The heavy-duty suspension system increases the flexibility of the discharge conveyor.

1 FT 6 IN (450 MM) PLATE LIFT ON RIGHT SIDE

The right-hand side plate can be raised by up to 1 ft 6 in (450 mm) to allow flush-to-curb milling. This feature allows the curb to be used as a reference when working at large milling depths.

AUTOMATIC WATER INJECTION

The amount of water injected to cool the picks increases automatically relative to the increase in engine load. Water consumption can also be directly adjusted electrically from the operator's platform.



WIDE CONVEYOR SWING ANGLES

Large conveyor swing angles of 60° to both sides make it possible to load material even in difficult situations, e.g. in intersections or turning areas.

TWO CONVEYOR SWING SPEEDS

The discharge conveyor can swing slowly to ensure precise loading of the milled material or quickly, thus optimizing the entire milling process.

HYDRAULIC FOLDING CONVEYOR

The hydraulic folding conveyor can be folded away quickly for easy transport and to adapt to site conditions.



The discharge conveyor has a large swing range.

Milling and Loading Highlights

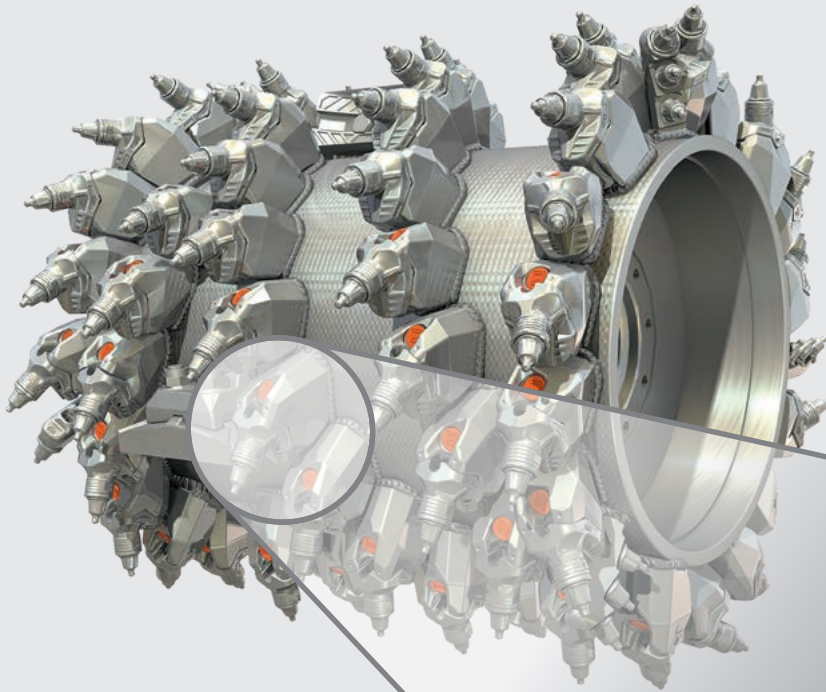

EXTREMELY WEAR-RESISTANT HT22 QUICK-CHANGE TOOLHOLDER SYSTEM

The W 120 XTi's milling drums are equipped with the **HT22** quick-change toolholder system, making them perfect for highly demanding milling tasks. In addition, the heavy-duty milling drum design enables the upper parts of the quick-change toolholders to be changed quickly on site, if required.

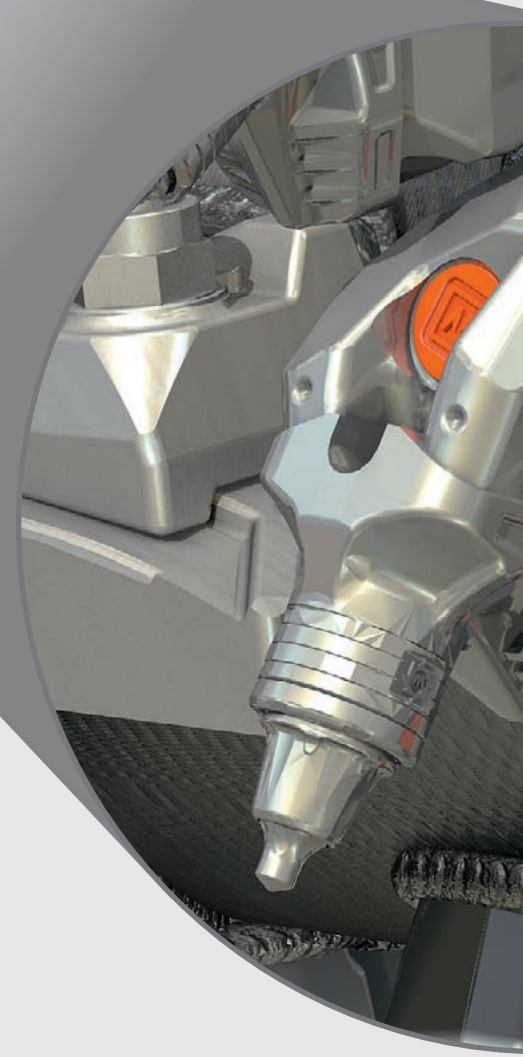

NEW HT22 **PLUS** TOOLHOLDER UPPER PART WITH INCREASED SERVICE LIFE

The new **HT22 PLUS** quick-change toolholder upper part features innovative centering marks on the tool contact surface. In combination with the new X² generation of picks, this reduces toolholder wear by up to 25% and also optimizes the rotation behavior of the picks. The new upper part offers considerable benefits such as higher milled surface quality and longer intervals between changes.

HT22 PLUS QUICK-CHANGE TOOLHOLDER SYSTEM IN DETAIL

- 1 | Innovative centering marks on the tool contact surface in combination with GENERATION X² picks for maximum toolholder service life right from the start
- 2 | Long service life of upper part due to extremely large wear distance
- 3 | Increased wear volume in the shoulder section improves protection of the toolholder base when milling abrasive materials
- 4 | Reduced maintenance requirements due to longer intervals between torque inspections of the quick-change toolholder bolts (every 500 hours)
- 5 | Optimized shaft geometry with additional improved thermal processing to withstand extreme stress
- 6 | Protective plug prevents bolt head from getting dirty
- 7 | Heavy-duty retaining bolt
- 8 | Seal between top and bottom part allows top part to be easily removed/inserted
- 9 | Bottom part covers top part completely for maximum protection
- 10 | Extra-large contact surface between top part and bottom part for longer bottom part service life
- 11 | Optimized welded joint with increased strength and flexibility for optimum pick rotation

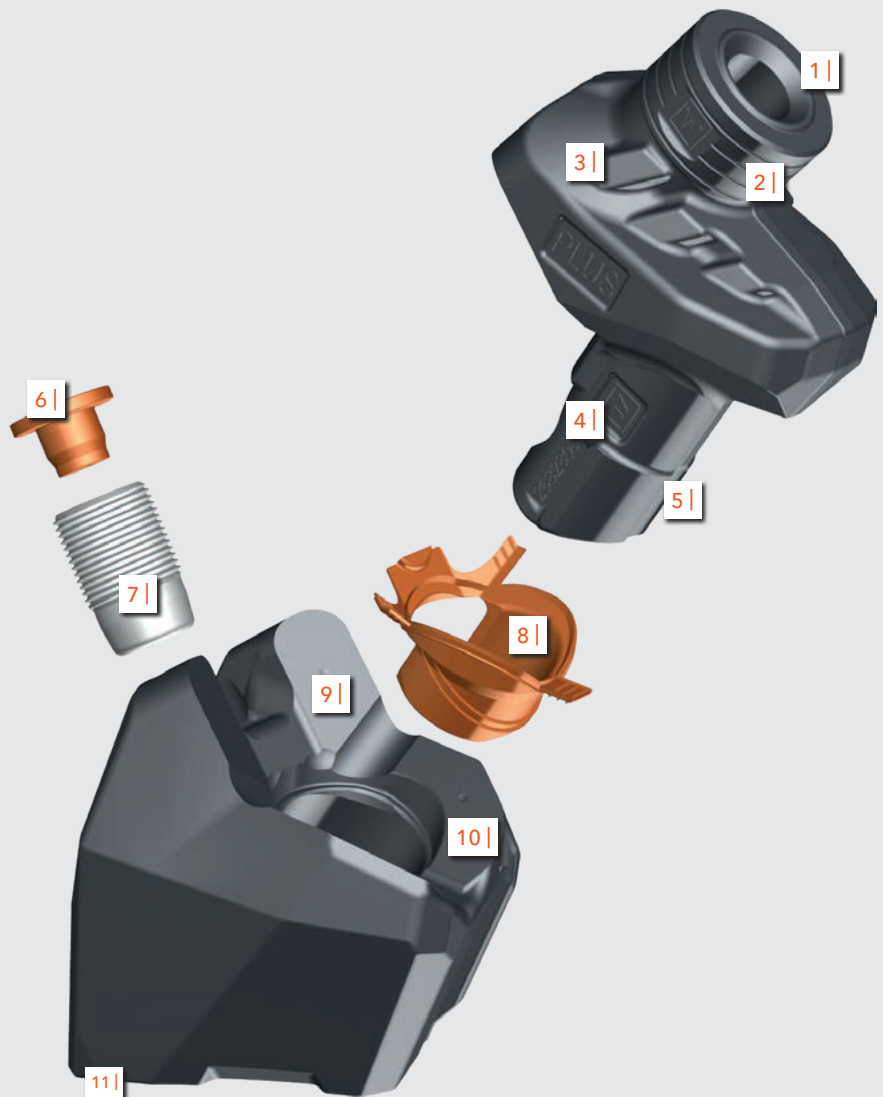

Ideal price-performance ratio due to perfectly compatible system components.

Performance and Productivity Highlights

12
13

EXHAUST GAS AFTERTREATMENT

In order to effectively treat exhaust gas, the diesel engine is equipped with an oxidation catalytic converter and an SCR catalytic converter and meets the requirements of the stringent US EPA Tier 4f emissions standard.

ENGINE COOLING

Cooling system with temperature-controlled fan speed for low noise emissions.

SCR CATALYTIC CONVERTER

SCR catalytic converter for reducing nitrogen oxides by adding a special diesel exhaust fluid.

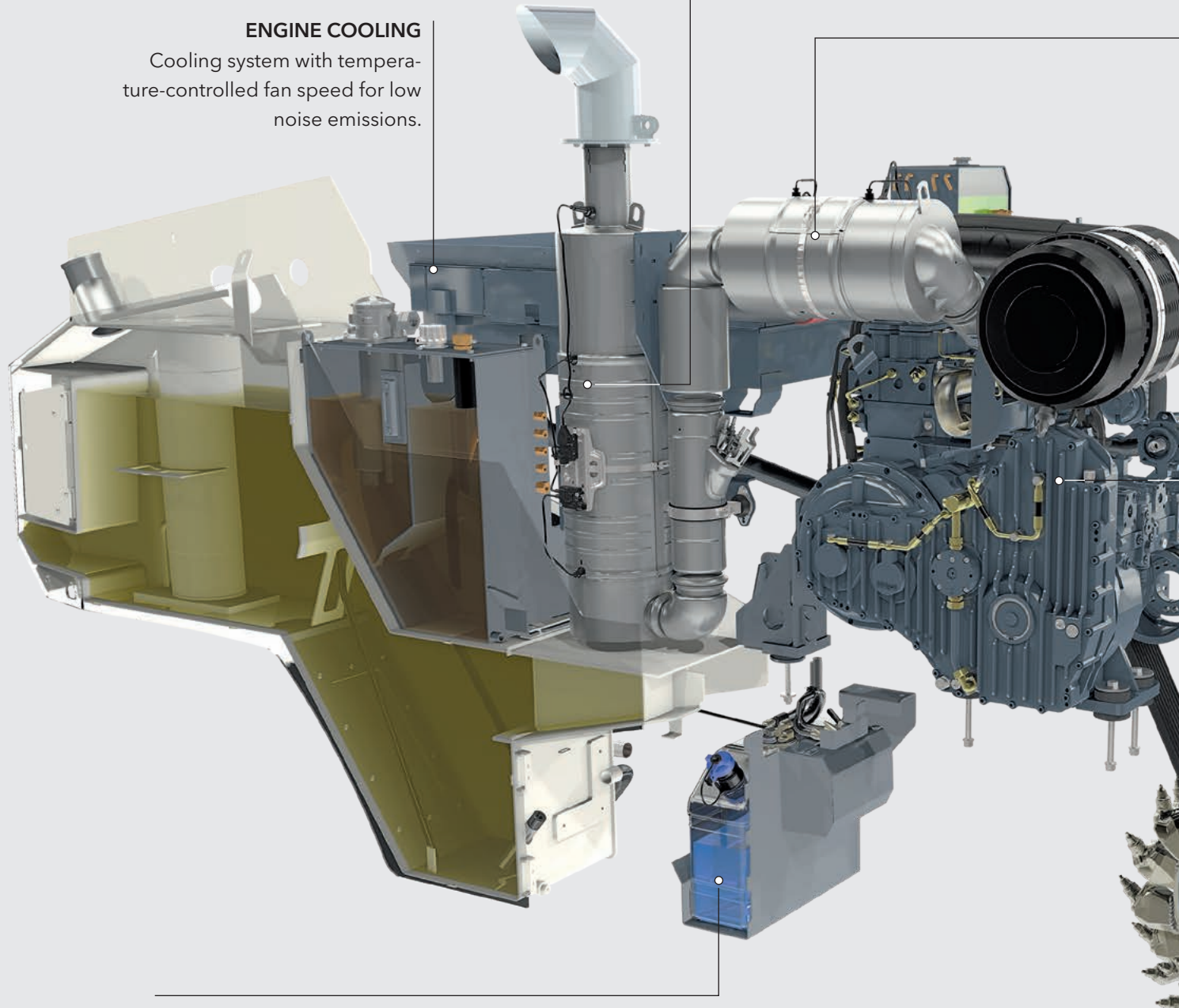

ADBLUE®/DEF TANK

Storage container for diesel exhaust fluid with easily accessible filling port.

MECHANICAL MILLING DRUM DRIVE

High-efficiency belt drive for reduced fuel consumption.



OXIDATION CATALYTIC CONVERTER

Catalyst for the oxidation of hydrocarbons and carbon monoxide.

HIGH-POWERED ENGINE

The significantly improved engine output with increased maximum torque guarantees fast, productive work, even at the maximum milling depth.

MODERN ENGINE TECHNOLOGY

The compact milling machine's engine technology complies with the strict requirements of the stringent US EPA Tier 4f emissions standard.

IMPRESSIVE ENGINE PERFORMANCE

The state-of-the-art diesel engine offers tremendous engine power with high maximum torque, guaranteeing fast operation and high production rates, even at the maximum milling depth.

THREE DIFFERENT MILLING DRUM SPEEDS

Three different milling drum speeds make it possible to achieve unparalleled milling performance in a wide range of applications.

AUTOMATIC POSITIONING FUNCTION

The automatic positioning feature uses relief sensors to prevent the rear track units from being lifted unintentionally.

AUTOMATIC WIDRIVE FUNCTIONS

The WIDRIVE machine control system offers numerous automatic functions to make the operator's daily work easier. In addition, WIDRIVE pays for itself through lower diesel consumption and increased daily production rates.

COMPACT DIMENSIONS AND LOW WEIGHT

The machine's optimized weight and compact dimensions make it easy to transport.

ENGINE CHARACTERISTICS W 120 XTi (US EPA TIER 4f)

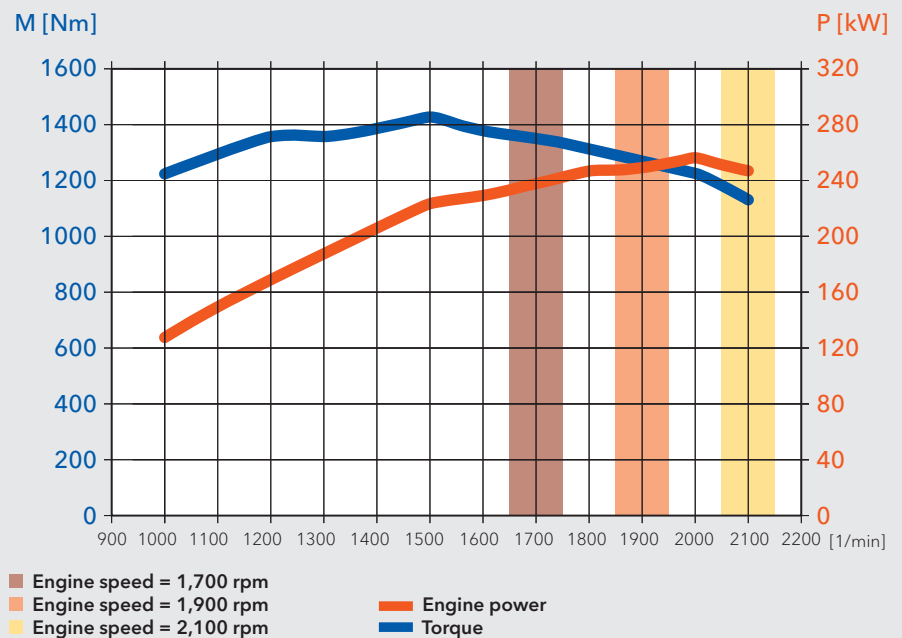

Technical Specifications

W 120 XT*i*

14
15

Milling Drum	
Milling width	3 ft 11 in (1,200 mm)
Milling depth * ¹	0 to 1 ft 1 in (0 to 330 mm)
Cutting diameter	3 ft 3 in (980 mm)
Engine	
Manufacturer	CUMMINS
Type	QSL 9
Cooling	Water
Number of cylinders	6
Rated power at 2,100 rpm	248 kW/333 HP/337 PS
Maximum power at 1,900 rpm	257 kW/345 HP/350 PS
Displacement	2.4 gal (8.9 l)
Fuel consumption at rated power during a mixture of job site operations	17.7 gal/h 7.1 gal/h (67 l/h 27 l/h)
Sound power level in accordance with DIN EN 500-2 engine operator's platform	≤ 103 dB(A) ≥ 80 dB(A)
Emissions standard	US EPA Tier 4f
Electrical System	
Power supply	24 V
Tank Capacities	
Fuel	161.1 gal (610 l)
AdBlue®/DEF * ²	9.2 gal (35 l)
Hydraulic fluid	34.3 gal (130 l)
Water	422.7 gal (1,600 l)
Driving Performance	
Max. milling speed	0 to 141 ft/min (1.6 mph) (0 to 43 m/min (2,6 km/h))
Max. transport speed	0 to 318 ft/min (3.6 mph) (0 to 97 m/min (5,8 km/h))
Track Units	
Track chains front/back (L x W x H)	4 ft 4 in x 10.2 in x 1 ft 10 in (1,330 x 260 x 550 mm)
Loading of Milled Material	
Belt width of primary conveyor	2 ft 2 in (650 mm)
Belt width of discharge conveyor	1 ft 12 in (600 mm)
Theoretical capacity of discharge conveyor	230.2 yd ³ /h (176 m ³ /h)

*¹ = The maximum milling depth may deviate from the value indicated due to tolerances and wear.

*² = AdBlue® is a registered trademark of the German Association of the Automotive Industry (VDA)

Weight of Standard Machine	
Empty weight of machine without fluids	45,636 lbs (20,700 kg)
Operating weight, CE* ³	48,281 lbs (21,900 kg)
Maximum operating weight (full tanks, full range of equipment)	51,588 lbs (23,400 kg)
Weight of Tank Contents	
Water	3,527 lbs (1,600 kg)
Fuel (6.9 lbs/gal (0.83 kg/l))	1,116 lbs (506 kg)
AdBlue®/DEF* ² (9.2 lbs/gal (1.1 kg/l))	85 lbs (38.5 kg)
Additional Weight	
Operator and Tools	
Machine operator	165 lbs (75 kg)
5 pick buckets	276 lbs (125 kg)
Vehicle tool kit	66 lbs (30 kg)
Optional Additional Equipment	
Hydraulically lowering weather canopy instead of standard	441 lbs (200 kg)
VCS extraction system	276 lbs (125 kg)

*³ = Machine weight, half-full tanks, vehicle tool kits, machine operator, excluding optional equipment

Dimensions

W 120 XT*i*

16
17

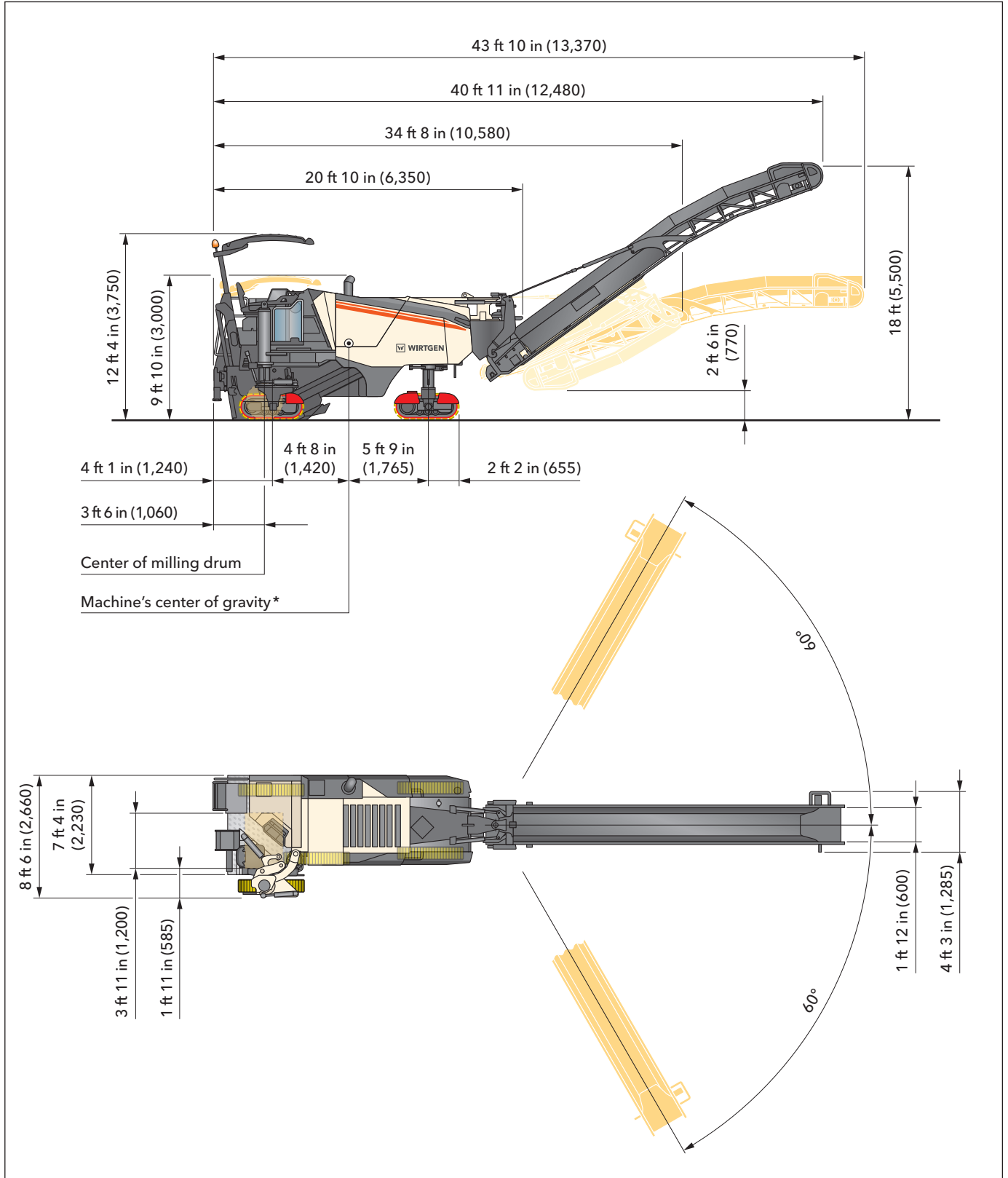

Dimensions in American standard and mm
* = Based on operating weight, CE with conveyor folded out

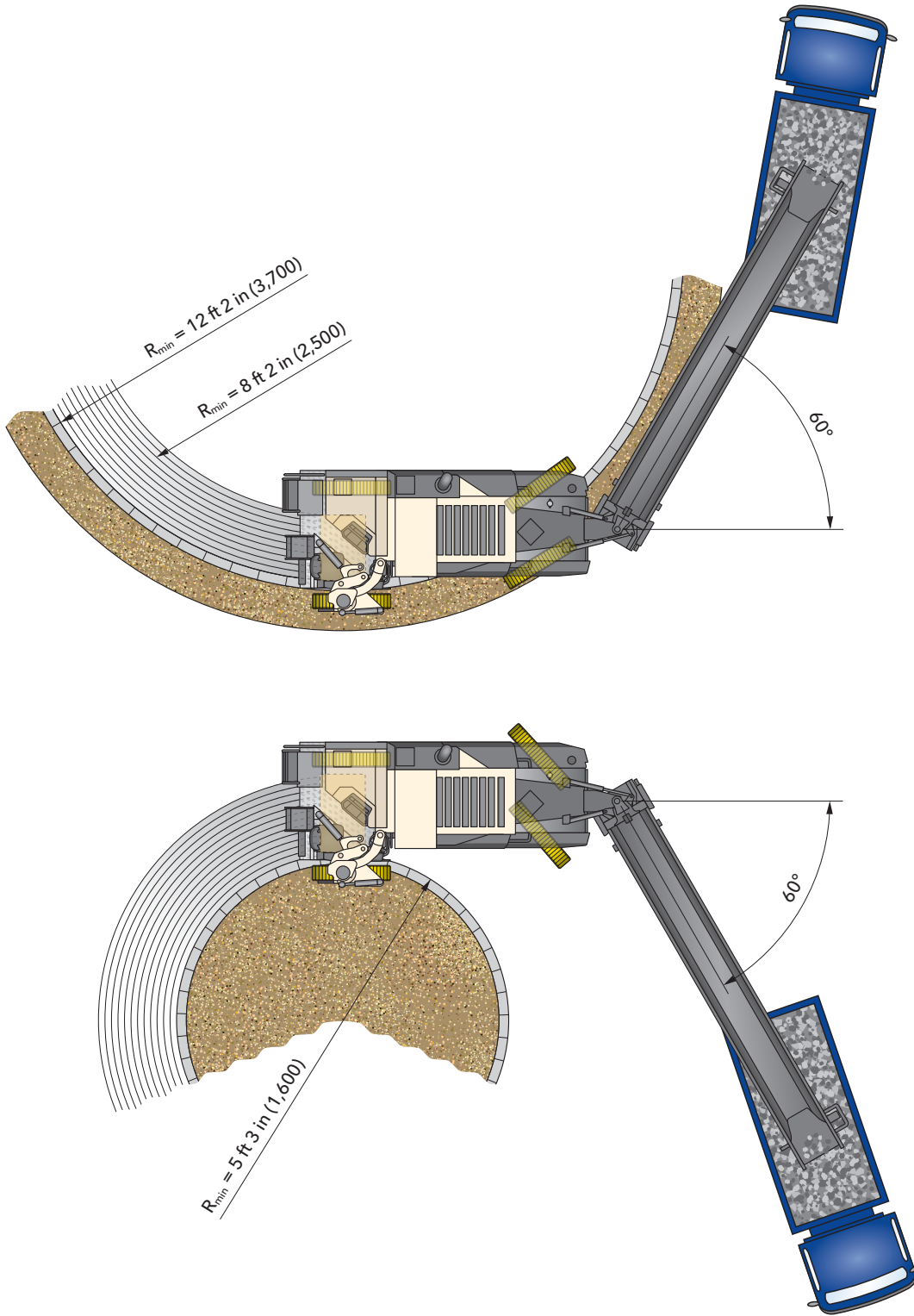

Milling radius, milling depth 5.9 in (150 mm), dimensions in American standard and mm

Standard Equipment

W 120 XT*i*

18
19

Base Machine	
Mechanically opening engine cover with noise insulation	■
Highly effective noise insulation throughout the engine compartment	■
Automatic engine speed adjustment depending on machine load	■
Diesel oxidation catalyst (DOC) for exhaust gas aftertreatment	□
Milling Drum Unit	
The right-hand side of the milling drum housing can be easily opened for maintenance or drum change	■
Hydraulically operated rear scraper with mechanical locking	■
Milling drum housing FB1200	□
Milling Drums	
Milling drum FB1200 HT22 LA15 with 115 picks	□
Loading of Milled Material	
Discharge conveyor swing angle: 60 degrees left - 60 degrees right	■
Hydraulically foldable discharge conveyor with two swing speeds, including adjustable conveyor speed for precise loading	■
Discharge conveyor, 26 ft 9 in (8,150 mm) long, 1 ft 12 in (600 mm) wide, with hydraulic folding device	□
Machine Control and Leveling	
Digital milling depth indicator on machine control panel	■
LEVEL PRO PLUS leveling system right and left	■
RAPID SLOPE cross-slope sensor for LEVEL PRO PLUS leveling system	■
Precise machine height adjustment in increments of 0.04 or 0.2 in (1 or 5 mm) via the machine's main control panel	■
Digital load control, can be engaged manually, hydraulic differential lock (via flow divider)	■
Operator's Platform	
Hydraulically extendable operator's platform for optimum view of the working area	■
Mirror package consisting of front left and right rear-view mirrors and a forward-facing mirror to the left of the operator's platform	■
Reversing horn with clearly audible signal	■
Scraper height indicator on control panel	■

- = Standard equipment
- = Standard equipment, can be replaced with optional equipment if desired
- = Optional equipment

Standard Equipment

W 120 XT*i*

Track Unit and Height Adjustment	
Dual-speed hydraulic height adjustment of front and rear track units	<input checked="" type="checkbox"/>
Miscellaneous	
Towing device	<input checked="" type="checkbox"/>
Comprehensive safety package with several EMERGENCY STOP switches	<input checked="" type="checkbox"/>
European type certification, EuroTest mark, and CE conformity	<input checked="" type="checkbox"/>
Standard painting in RAL 9001 (cream)	<input type="checkbox"/>
WITOS FleetView (MF1, 3G) - professional telematics solution for machine operation and service optimization	<input type="checkbox"/>

Optional Equipment

W 120 XT*i*

Loading of Milled Material	
VCS extraction system	<input type="checkbox"/>
Machine Control and Leveling	
Active floating position for the side plates, left and right	<input type="checkbox"/>
Job data determination in the control panel's display	<input type="checkbox"/>
Operator's Platform	
Operator's platform with hydraulically lowerable weather canopy	<input type="checkbox"/>

- = Standard equipment
- = Standard equipment, can be replaced with optional equipment if desired
- = Optional equipment



WIRTGEN AMERICA Inc.
6030 Dana Way · Antioch, TN 37013, USA
Phone: (615) 501-0600 · Fax: (615) 501-0691
Internet: www.wirtgen-group.com/america

